



Flat 1, La Fontaine Court, 92 Windmill Road

£177,500 Leasehold

GROUND FLOOR MAISONETTE • LOUNGE WITH OPEN PLAN KITCHEN • GOOD SIZE DOUBLE BEDROOM WITH WALK IN WARDROBE • UPVC DOUBLE GLAZING • EXCELLENT ORDER • ALLOCATED PARKING



Council Tax band: B

Tenure: Leasehold

EPC Energy Efficiency Rating: E

EPC Environmental Impact Rating: D



- GROUND FLOOR MAISONETTE
- LOUNGE WITH OPEN PLAN KITCHEN
- GOOD SIZE DOUBLE BEDROOM WITH WALK IN WARDROBE
- UPVC DOUBLE GLAZING
- EXCELLENT ORDER
- ALLOCATED PARKING

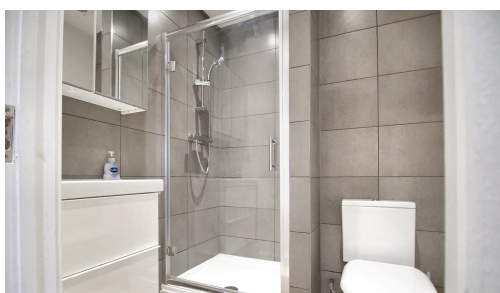

GROUND FLOOR
464 sq.ft. (43.1 sq.m.) approx.

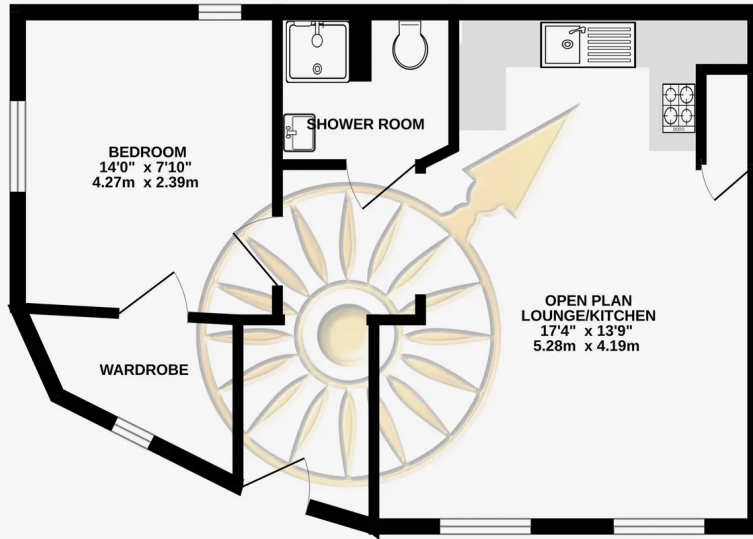

TOTAL FLOOR AREA: 464 sq.ft. (43.1 sq.m.) approx.
Whilst every attempt has been made to ensure the accuracy of the floorplan contained here, measurements of doors, windows, rooms and any other items are approximate and no responsibility is taken for any error, omission or mis-statement. This plan is for illustrative purposes only and should be used as such by any prospective purchaser. The services, systems and appliances shown have not been tested and no guarantee as to their operability or efficiency can be given.
Made with Metropix ©2023

You can include any text here. The text can be modified upon generating your brochure.